

AARCHITECTURE

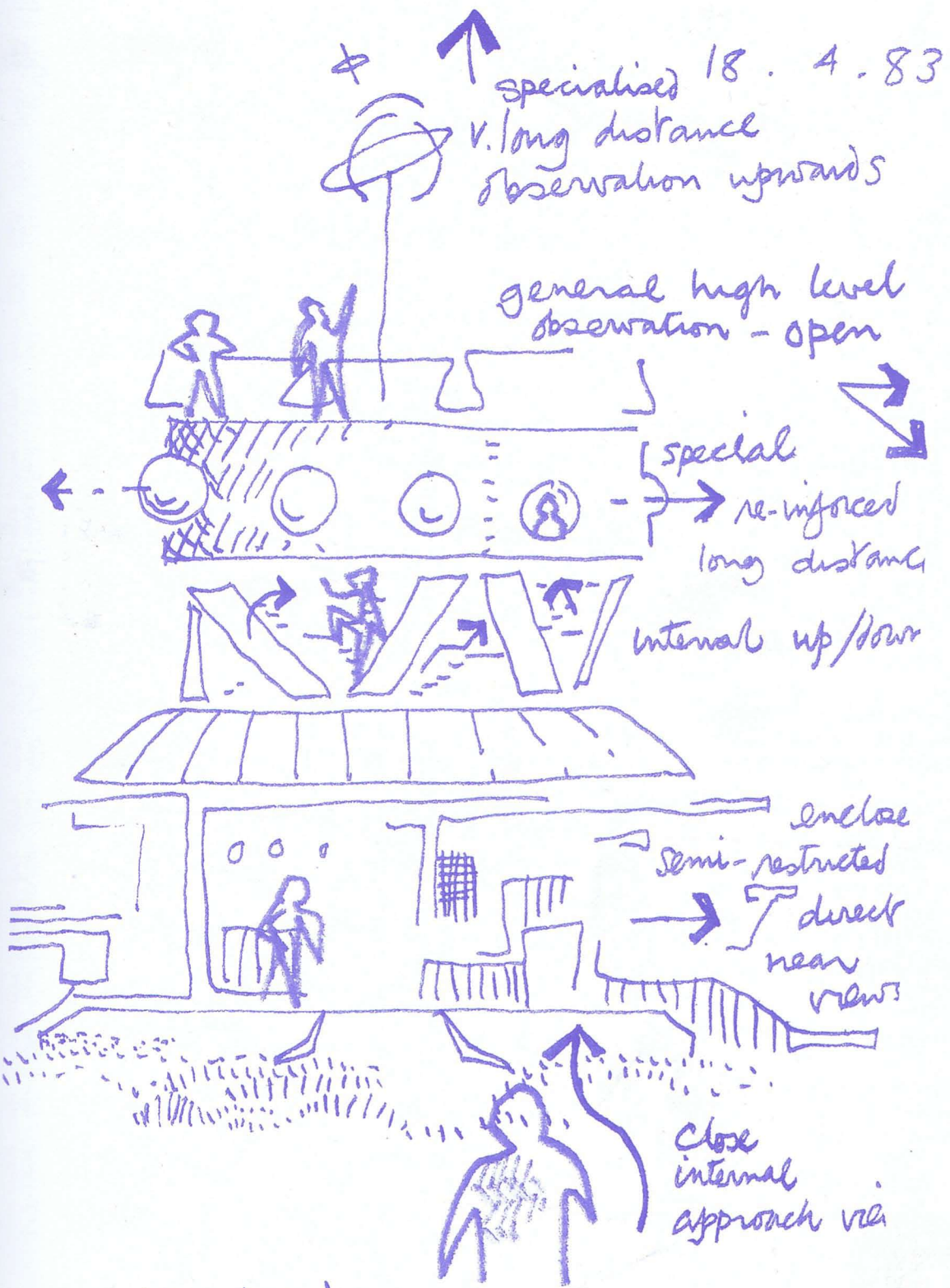

the looking machine

Faceted House 1

By Paul McAnearney Architects



Clutter-free concept kitchen with sliding glass doors and frameless folded roof panel.

Paul McAnearney Architects have recently completed Faceted House 1; an Edwardian terrace house located within a conservation area, in Hammersmith, London. The project's brief was to remodel and extend the three-bedroom, two storey house that was in a decrepit state and in need of considerable refurbishment and modernisation. The client asked for a contemporary design and functionality and he also expressed the desire to be able to perceive the garden as a continuation of the domestic space rather than 'the outdoors'.

Paul McAnearney Architects (PMA) responded to the brief by demolishing the existing 1980s rear extension to the property which was crumbling and dilapidated. The new extension was added via a clean and clearly defined line to the rear that respects the house's heritage and gives it a unique, uniform aesthetic. The sculptural façade is at the same time visually striking and elegant. The reconfigured and expanded existing space was achieved by designing a huge open-plan. The concept driving the whole design is a 30° twist that allows physical and perceptive overlapping between indoor and outdoor spaces, between garden and kitchen thresholds – so whilst at the sink you feel the garden is actually behind you. This conceptual idea is manifest in the details of the faceted zinc facade and the floating external deck, cut back to a fine angled edge.

Light floods into the house via the finest possible sections, making up the sliding doors,

combined with the large fixed frameless panels of the facade that fold back into the depth of the building with a frameless folded roof panel. A sharp beam is projected into the depth of the house which dances through the space during the hours of daylight and which is extenuated by the pale coloured floor and ceiling bouncing light to the other end of the house. A 'ballet of light' is the result.

PMA emphasise the importance of having a good client. As one of the earliest projects for his medium-sized office, Faceted House 1 was a unique opportunity due to the freedom the clients afforded the architects in the design and construction of the project. Their only request was a clutter-free and practical house allowing PMA near-autonomy in making most of the design decisions. Thus rather than just a pragmatic construction, the house takes on a conceptual playful approach using light and angular forms to make an architectural statement.

Faceted House 1 was included in the *Don't Move Improve!* exhibition at NLA and was awarded the Living Space Design of the Year at the 2010 Design Awards.

Paul McAnearney is an alumnus of the AA and a former AA Honorary Secretary

Faceted House 1, Alumni Project,
Hammersmith, London



Birds eye view of the 30° faceted angle that allows the overlap between the indoor and outdoor spaces.



Night view of the sculptural facade and the floating deck. Photos: Paul McAnearney Architects Ltd